



Sponsorship Deck



ABOUT US

CHALLENGER BASEBALL

Syracuse Challenger Baseball (SCB) was founded in 1982 with a mission to provide life-changing experiences through baseball for individuals with special needs. In 2003, Executive Director Dom Cambareri took the helm, leading SCB's expansion to make the league available to new players across the CNY Community. From 2010 to 2024, SCB has grown into the largest Little League Challenger Division in the world, and features nearly 250 players participating in Junior, Senior, and Adult Divisions.

In 2006, despite challenges presented by the lack accessible fields in the community, SCB nearly tripled in size under Cambareri's guidance. After the new skilled player Senior Division was added in 2007, Cambareri and league volunteers realized that SCB must embark on a bold new mission – to build a fully accessible multi-field complex that SCB players and all CNY athletes could call home – the Challenger Field of Dreams.

ABOUT US

CARRIER PARK “FIELD OF DREAMS” SUPERFIELD EXPANSION

In 2015, Little League’s new Challenger Division rules helped Syracuse Challenger Baseball’s (SCB) establish the new Adult Division, featuring players aged 21 and above. SCB’s unwavering commitment to the inclusion of players of all ages and with all differing abilities ensured that every special Challenger player would thrive on the baseball diamond for years to come.

In 2016, SCB realized its ten-year dream as the inspirational driving force behind the opening of the Challenger Field of Dreams at Carrier Park. This trailblazing facility featured state-of-the-art baseball diamonds, provided SCB with its own home fields, and empowered the players to experience the pure joy of playing that National Pastime side by side with their peers. The Carrier Park “Challenger” Field of Dreams currently features:

 2 ADA Championship level Baseball/Softball Diamonds

 4 ADA Full Size Basketball Courts with Adjustable Nets and Special Navigable Playing Surface

 ADA All-Assessable Playground





OVERVIEW

THE VISION



Inspired to make a difference for generations to come, Syracuse Challenger Baseball now envisions the “Super Field of Dreams” – a groundbreaking all-inclusive, adaptive, and competitive multi-sports turf field expansion of Carrier Park. This ambitious project will further showcase SCB’s community impact and create a welcoming space where everyone can witness the joy, excitement, and passion that special needs athletes can bring to sports and recreation.



The Super Field of Dreams project, with a targeted fundraising goal of \$9-10 million, is set to commence construction by Spring 2024. This cutting-edge initiative will elevate SCB’s ability to play all 250 athletes at one super site and deepen the connection between project donors and the incredible experiences provided by the SCB athletes



“If you build it, they will come.” The Super Field of Dreams is where the special needs players of Syracuse Challenger Baseball and athletes of all abilities will come to thrive together on the ballfield. The impact of the Super Field of Dreams will be profound as a leading cutting edge inclusive and competitive sports complex to be emulated by communities across America.

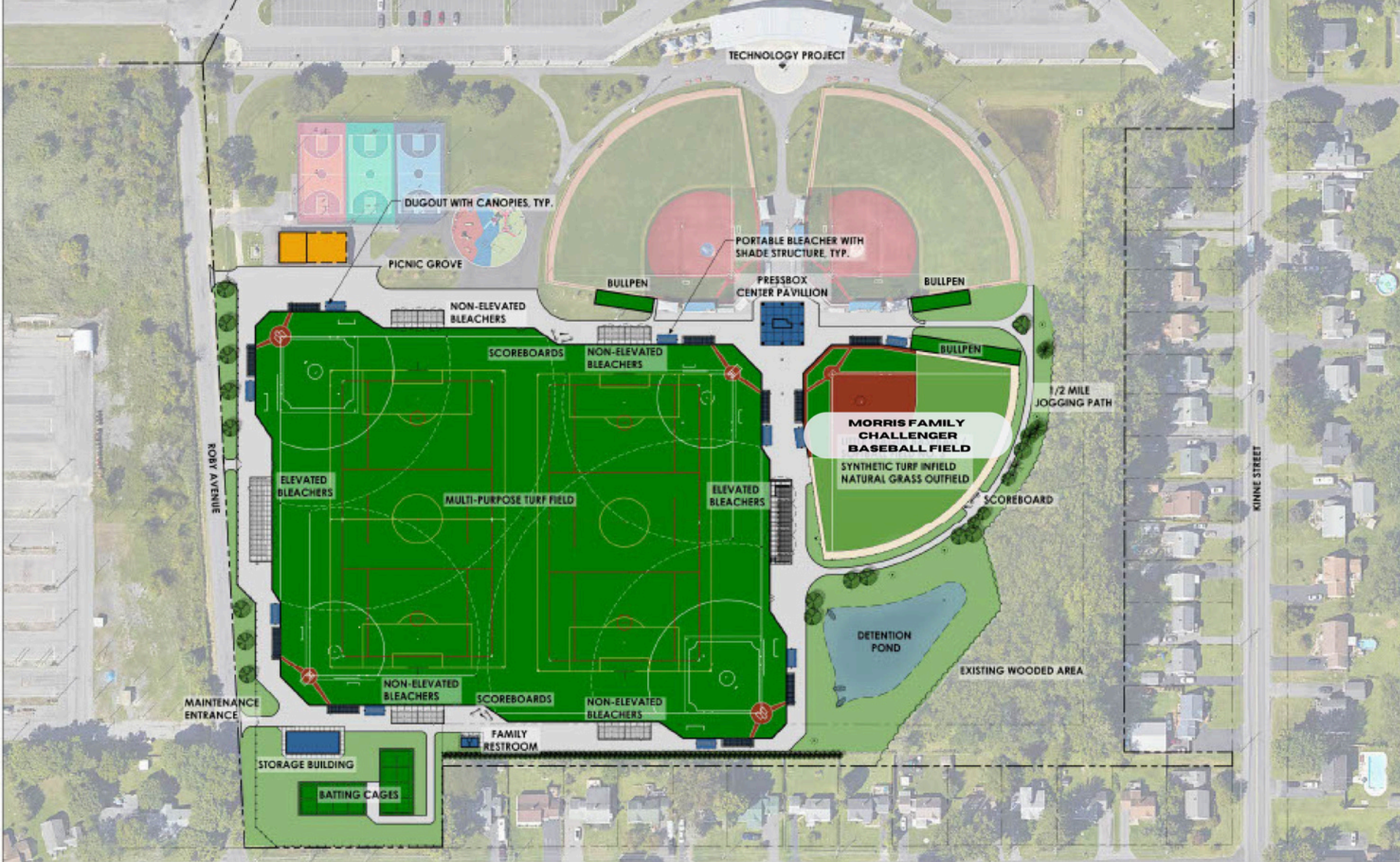

**8 FULLY
ACCESSIBLE
BASEBALL FIELDS**



**CUTTING-EDGE
HIGH-TECH LIVE
VIDEO STREAMING
SCOREBOARD**



**FLEX SUPERFIELD
FOR FOOTBALL,
LACROSSE, SOCCER
& MORE!**

OVERVIEW

THE VISION

Join us in making this dream a reality and contribute to the Super Field of Dreams project. Together, let's create a space where the magic of Syracuse Challenger Baseball continues to unfold, leaving an indelible mark on the lives of our players and their families.

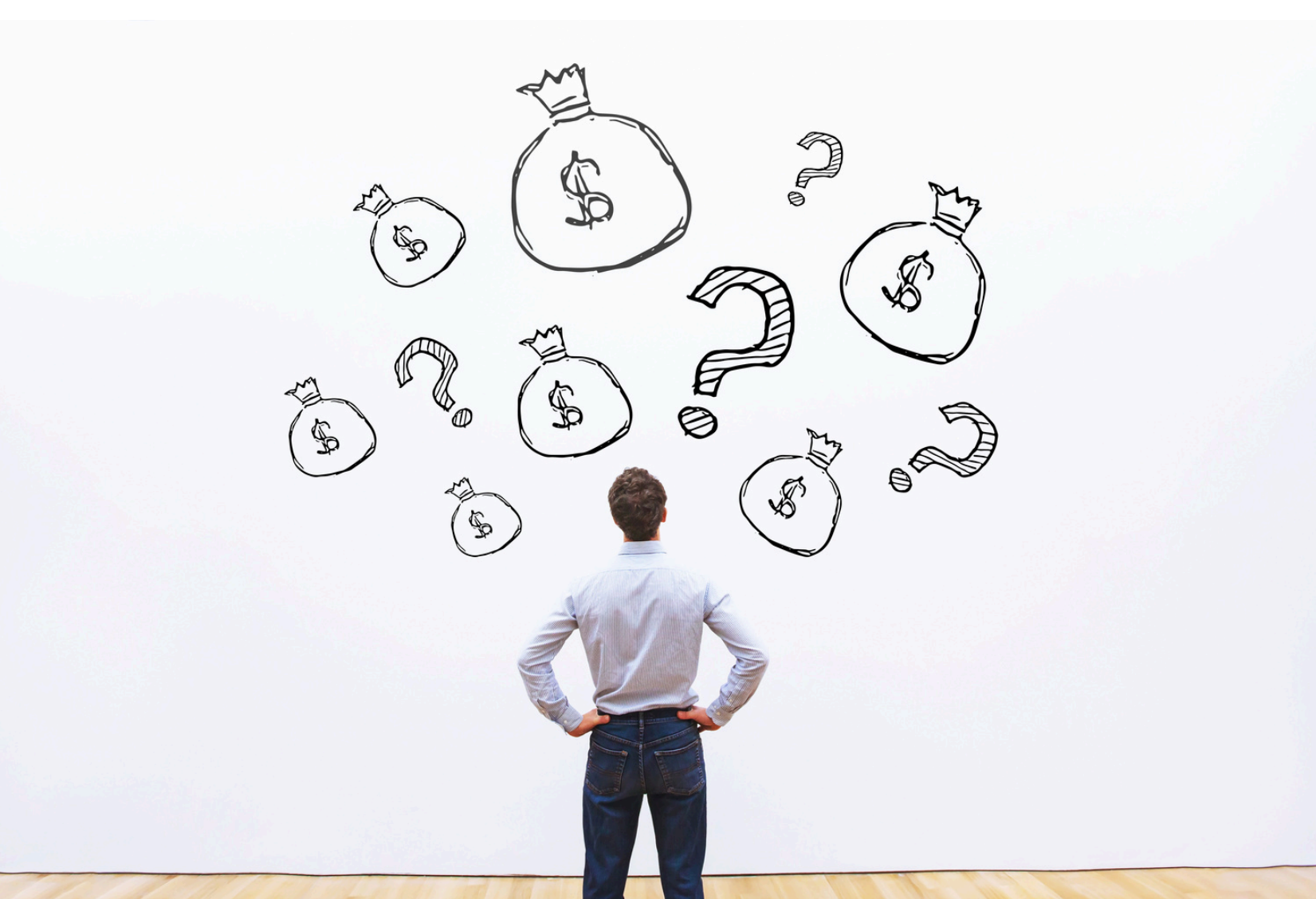

PHASE 3 ESTIMATED COST \$17 MILLION

FUNDS COMMITTED TO DATE

\$7.5 MILLION - TOWN OF DEWITT BOND*
\$850,000 - DEWITT HOTEL TAX REVENUE (ESTIMATED)
\$1.5 MILLION PRIVATE DONORS
\$1 MILLION - ONONDAGA COUNTY

FINANCIAL NEED

PHASE 3

The Friends of Town of Dewitt Parks & Recreation has worked diligently with the Town of DeWitt and other community members to fund the building of Carrier Park. Through Community Events, private donors and the Town of DeWitt obtaining a Bond to cover the initial construction costs, we are ready to break ground on the final phase!

FUNDRAISING GOAL 2024-2025 \$6,150,000

***The bond obtained by the Town of DeWitt will be reduced through the Hotel Tax and other fundraising revenues after the completion of Carrier Park**

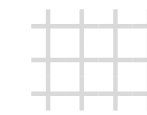

COMMUNITY PHILANTHROPISTS

ROB MORRIS

"IT GIVES MY WIFE, MARY HELEN, AND I GREAT PLEASURE TO SUPPORT THE BUILDING OF THE MORRIS FAMILY FIELD FOR CHALLENGER LITTLE LEAGUE BASEBALL SO THESE PLAYERS AND THEIR FAMILIES CAN HAVE THE INCREDIBLE EXPERIENCE OF TEAMWORK, BASEBALL, AND COMMUNITY."



JOHN & LAURA LALLY

"ATTEND ONE GAME AT CARRIER PARK, AND YOU WILL WITNESS FIRSTHAND THE EPITOME OF CENTRAL NEW YORK'S SPIRIT — SOMETHING MUCH BIGGER THAN ANY ONE OF US."



JIM & JULI BOEHEIM

"WE ARE THRILLED TO CONTINUE SUPPORTING THE CARRIER PARK FIELD OF DREAMS AND BUILD A SUPER FIELD! IT IS AN AMAZING RESOURCE FOR OUR COMMUNITY."



THE LOBDELL FAMILY

"IMAGINE THE IMPACT WE CAN MAKE BY CREATING A SPACE WHERE SPECIAL NEEDS ATHLETES FROM ACROSS NEW YORK, THE ENTIRE EAST COAST OF THE UNITED STATES, AND EVEN CANADA CAN COME TOGETHER IN THE SPIRIT OF SPORTSMANSHIP AND UNITY"





SU lineman and 1982 graduate John Lally and his wife Laura created The Lally Zone for athletes with physical and intellectual disabilities and their families.

GETTING IN THE ZONE

SU alum ensures a game-changing inclusive experience for athletes with disabilities

IN THE NEWS

THE DAILY ORANGE

NEWS ▾ CULTURE ▾ SPORTS ▾ OPINION ▾ MEDIA ▾ CUSEHOUSING

BASEBALL

After World Series appearance, Syracuse Challenger Baseball is vying for their Super Field of Dreams



Syracuse Challenger Baseball Participates in Little League World Series

The local program for special needs athletes achieved a milestone recently.

SYDNEY SUPPLE • AUG 30, 2023 8:09 PM EDT



Syracuse Challenger Baseball



OPPORTUNITY

SPONSORSHIP TIERS

★ **GRAND SLAM TITLE SPONSOR**
\$5,000,000

- Exclusive Naming Rights for the Superfield
- Premier Logo Placement
- VIP Experiences and Recognition





OPPORTUNITY

SPONSORSHIP TIERS

CHALLENGER FIELD
\$1,000,000

- Exclusive Naming Rights for Challenger field
- Premier Ad Placement
- VIP Experiences & Recognition

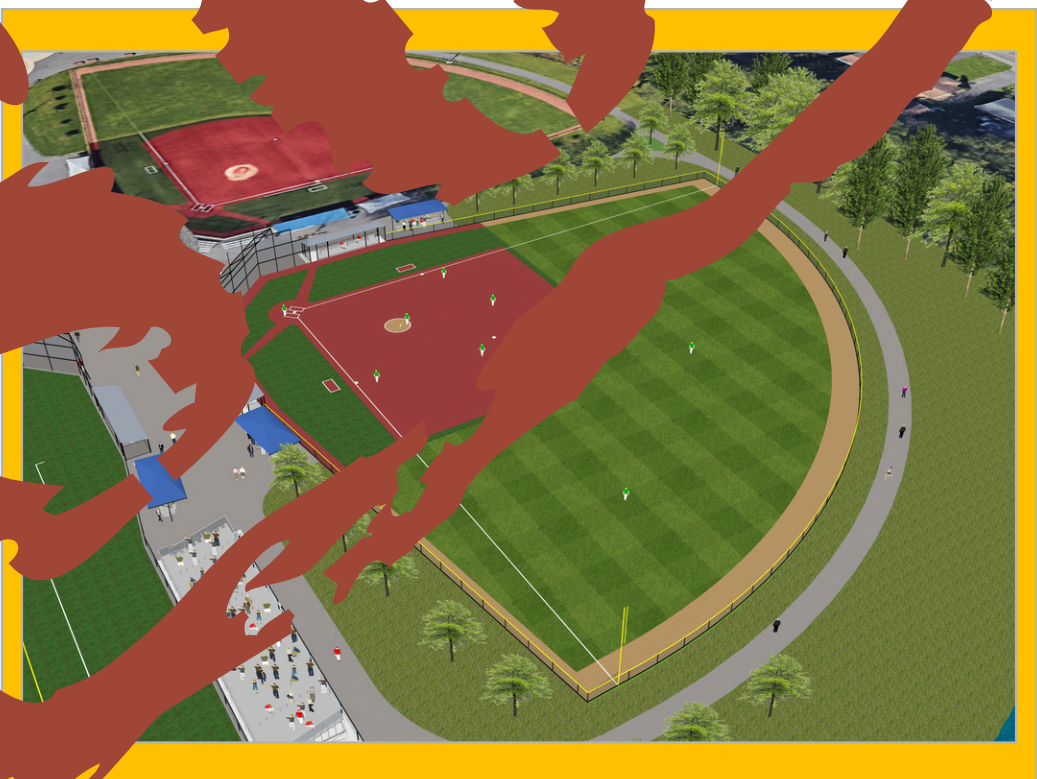
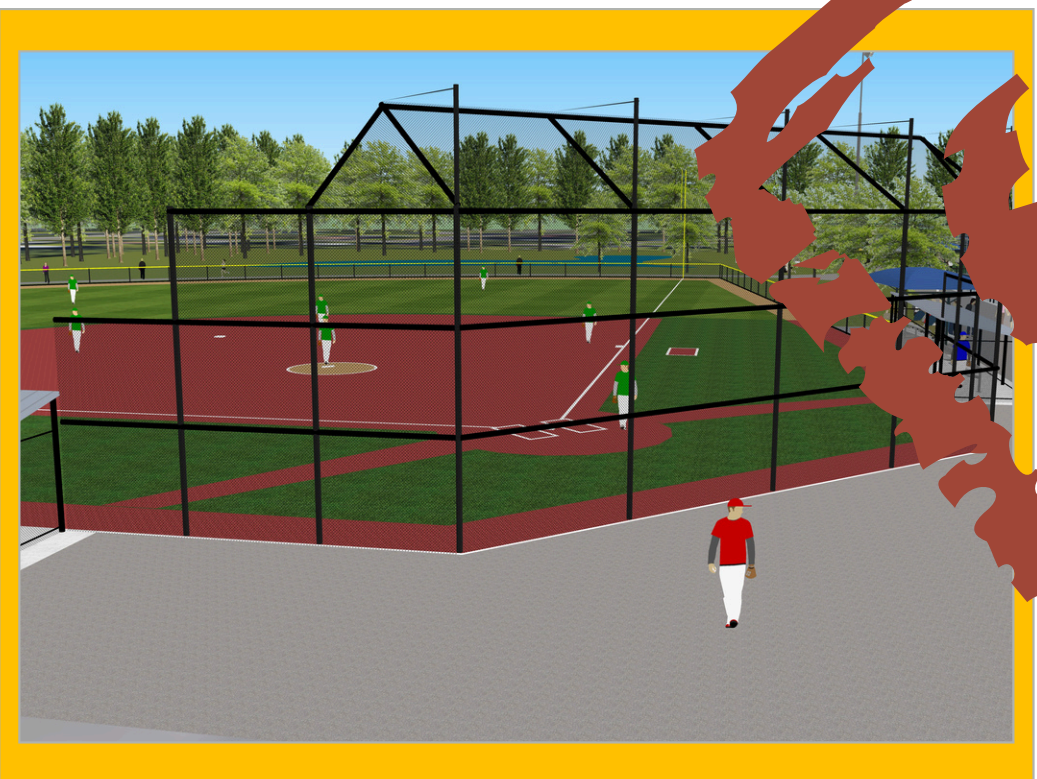



OPPORTUNITY

SPONSORSHIP TIERS

★ **TECHNOLOGY PAVILION**
\$1,500,000

- Includes the Technology Pavilion at the center of the park
- Premier Logo Placement
- VIP Experiences and Recognition

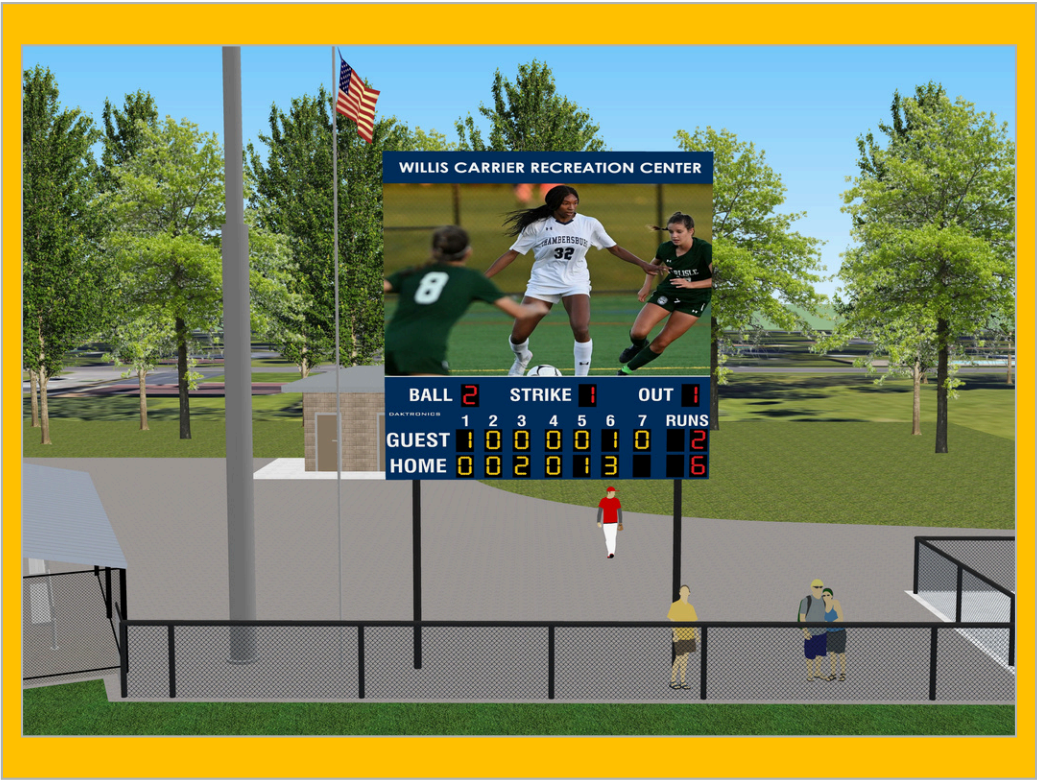



OPPORTUNITY

SPONSORSHIP TIERS

SCOREBOARDS

\$475,000

- Located on the Superfield
- Includes the large video board
- Premium Logo Placement
- VIP Experience and Recognition

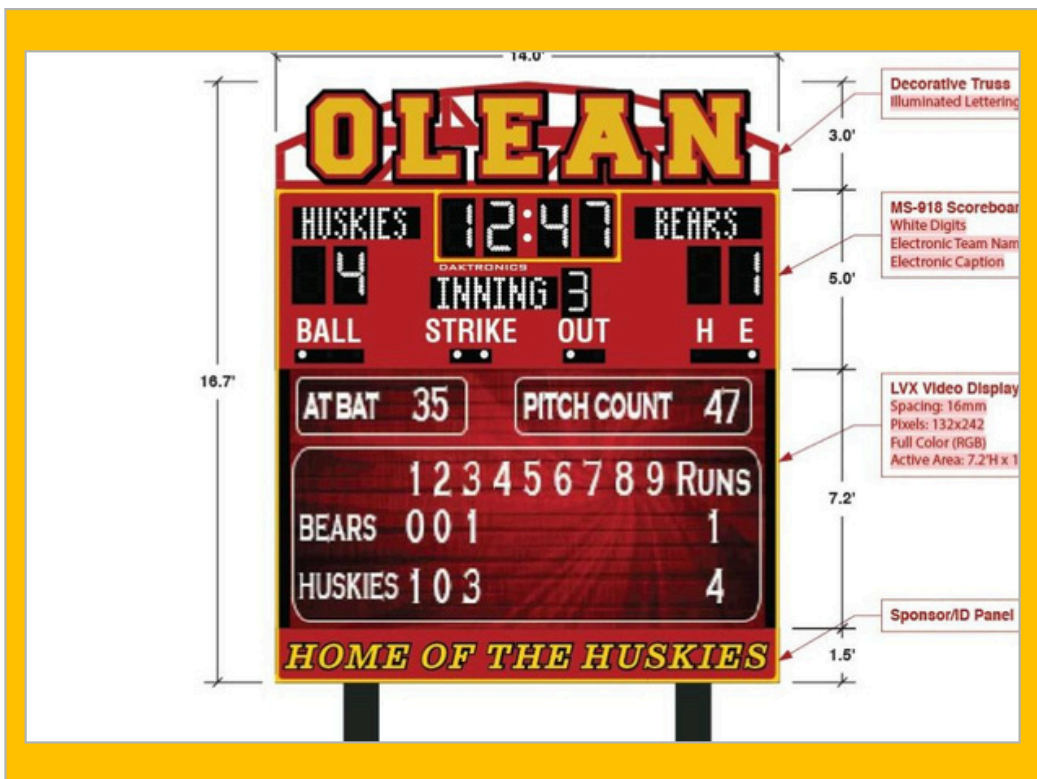
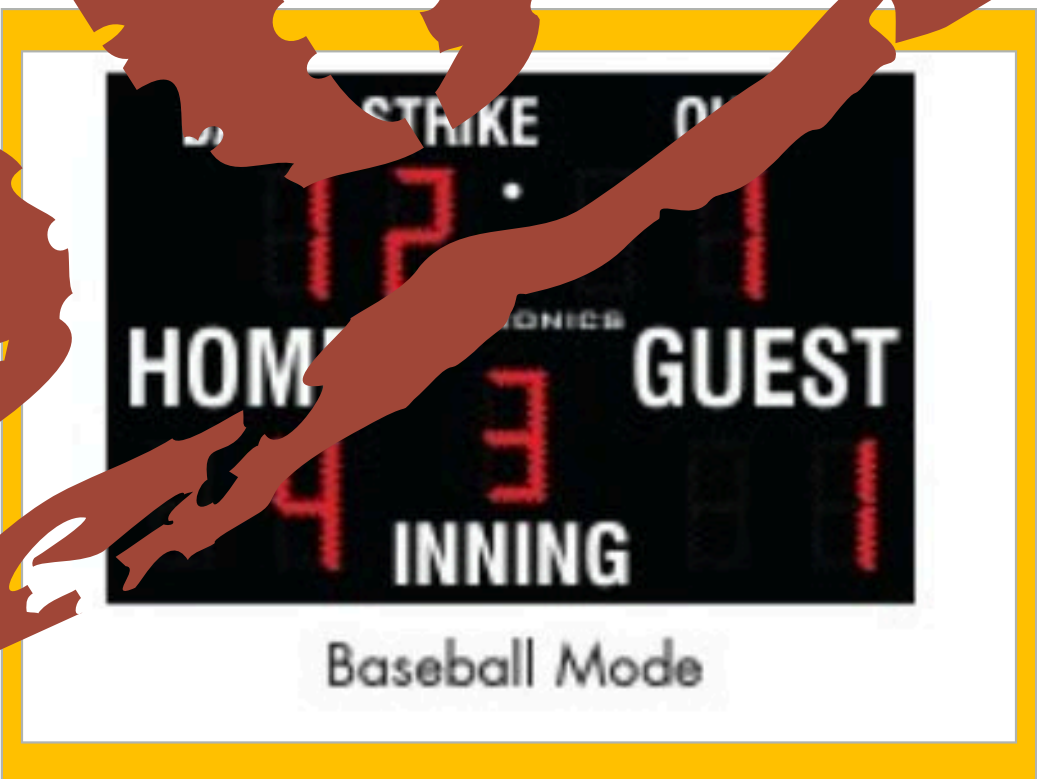
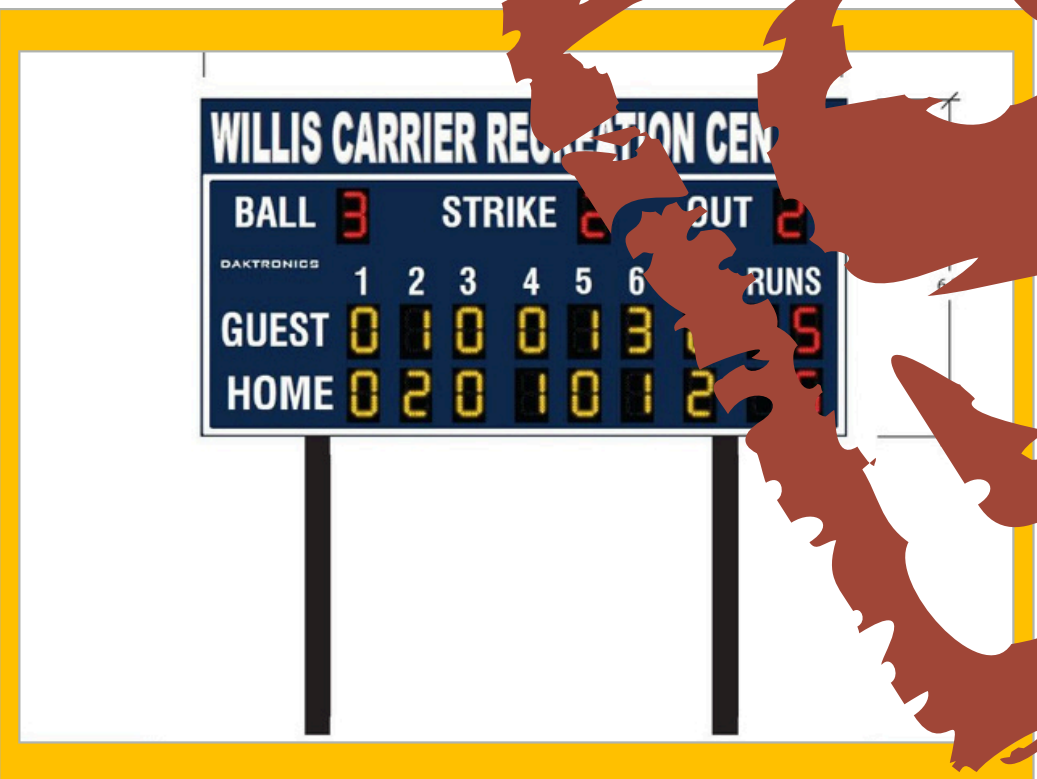



OPPORTUNITY

SPONSORSHIP TIERS

★ BATTING CAGES \$250,000

- Exclusive Naming Rights to the Batting Cage area of the Park
- Premier Logo Placement
- VIP Experiences and Recognition

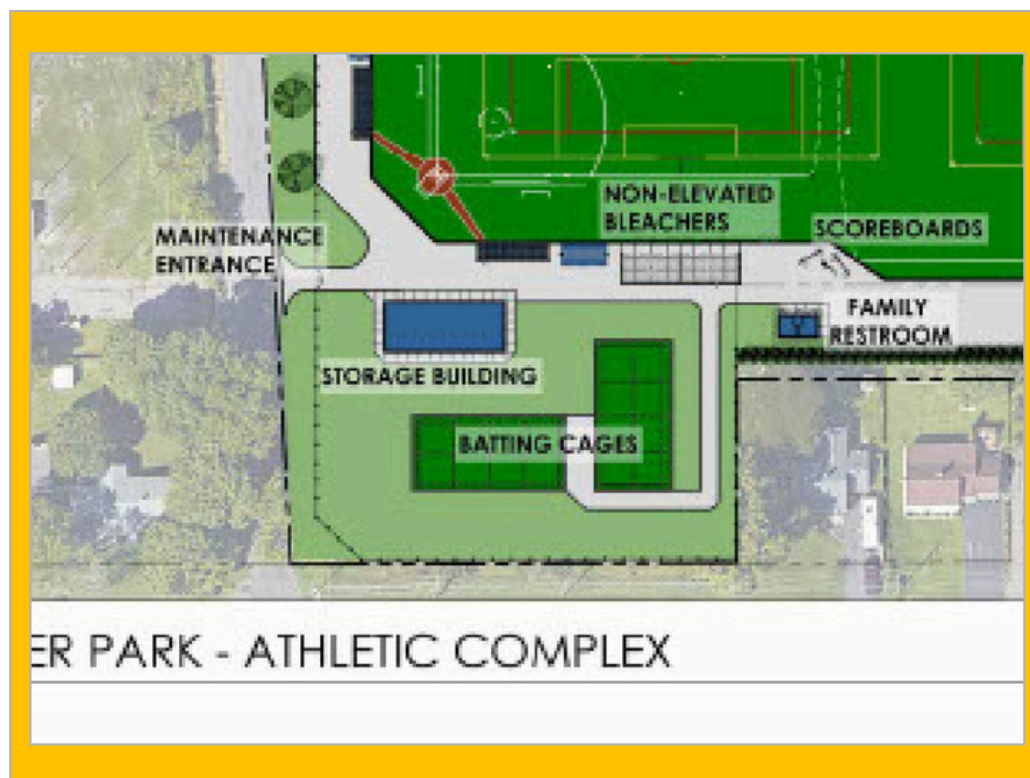



OPPORTUNITY

SPONSORSHIP TIERS

★ **BULL PENS (3 AVAILABLE)**
\$100,000

- Includes one Bull Pen located with in the Clover
- Premier Logo Placement
- VIP Experiences and Recognition

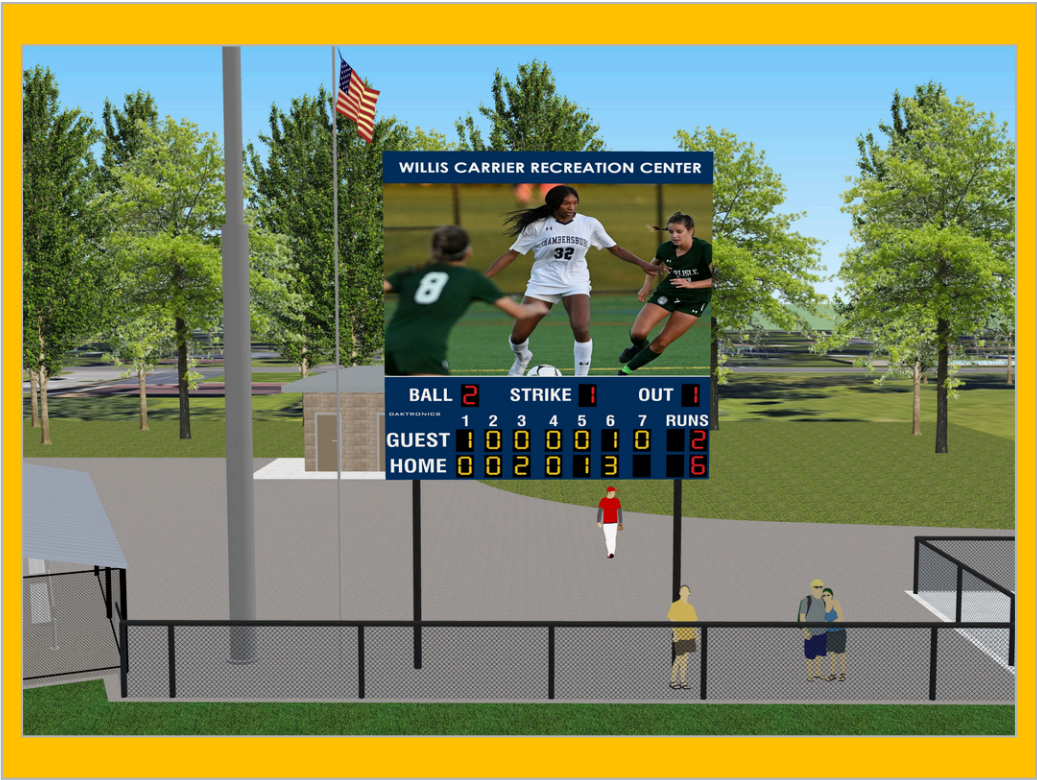

OPPORTUNITY



SPONSORSHIP TIERS



★ WALL OF FAME \$1,000-\$4,999 LEVELS

- Various Sized Engraved Plaques on the Wall of Fame
- Social Media Shout-outs
- Inclusion in Wall of Fame Ceremonies
- Photos are examples and plans for the wall are in development.

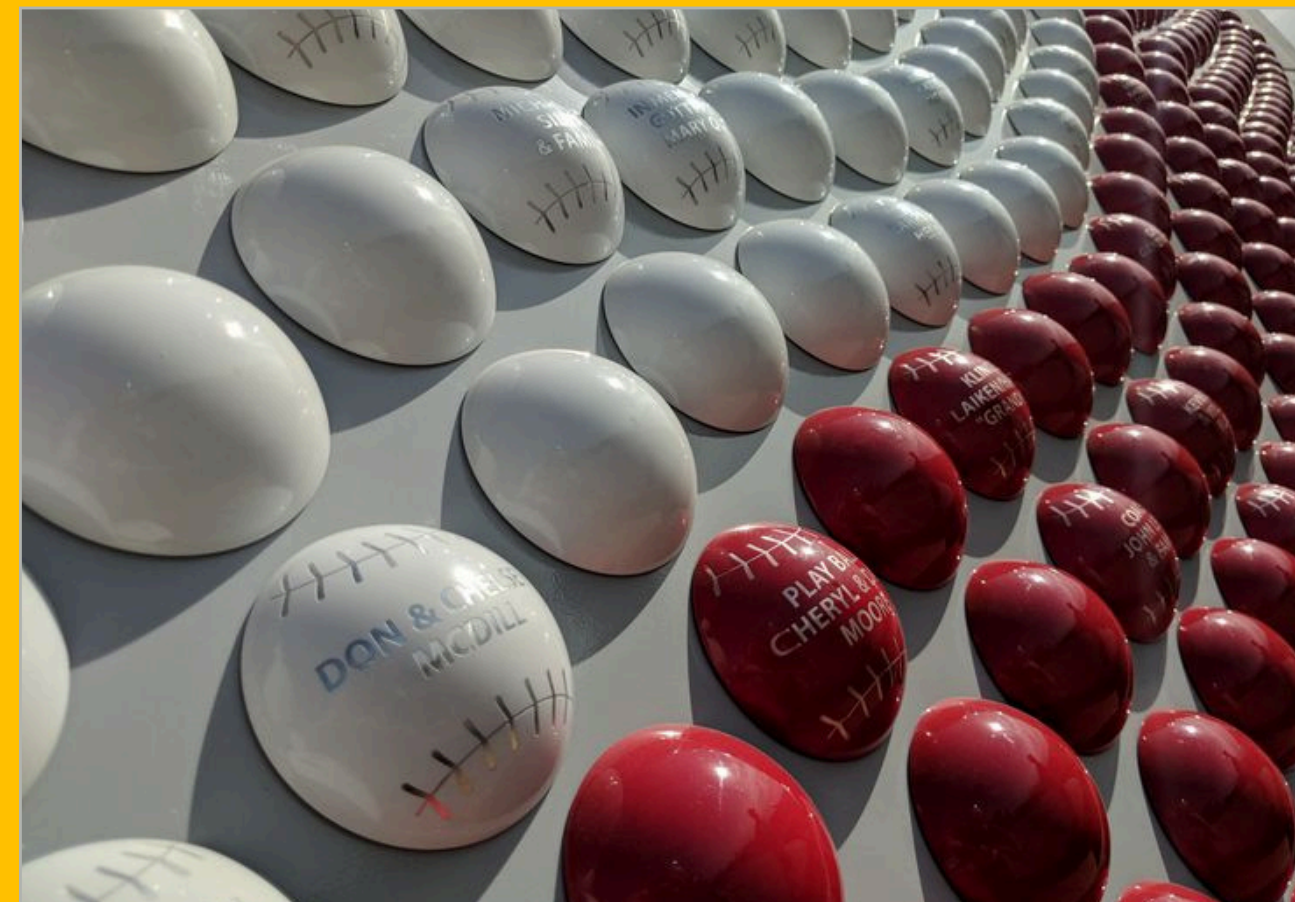



OPPORTUNITY

SPONSORSHIP TIERS

★ **GROUND BALL LEVEL**
\$5,000

- Logo Display on Prominent Areas
- Online Promotion and Acknowledgment
- Invitations to VIP Events

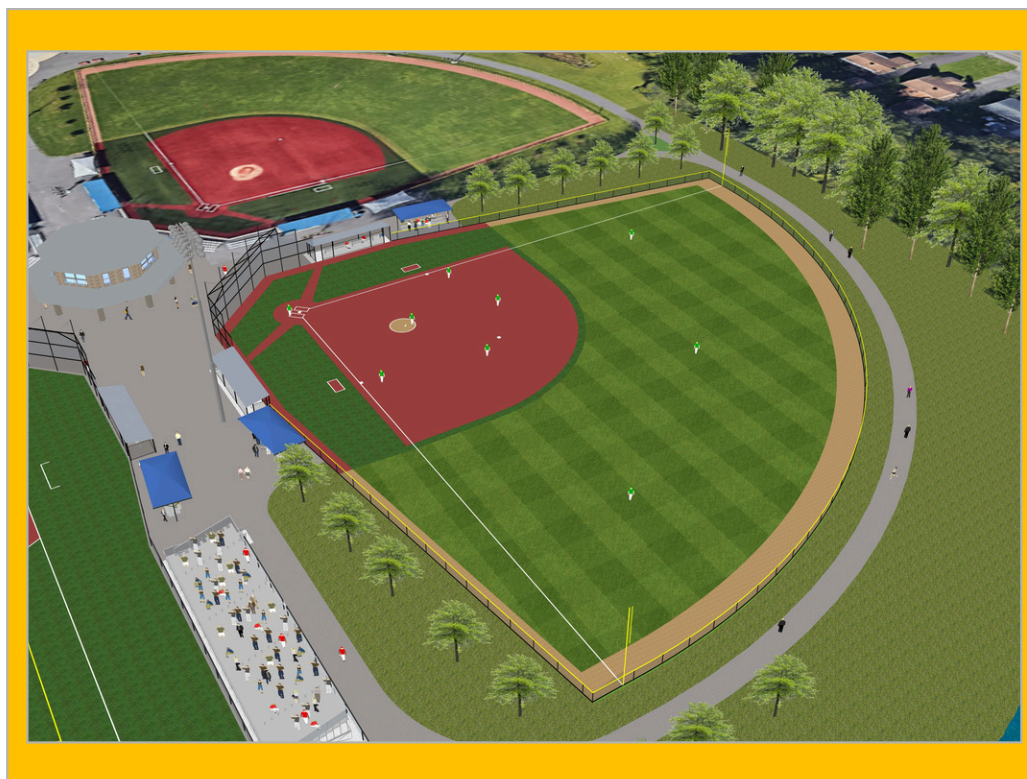



OPPORTUNITY

SPONSORSHIP TIERS

★ **DOUBLE PLAY LEVEL**
\$10,000

- Logo Visibility on Signage and Materials
- Social Media Mentions
- Special Recognition at Events





OPPORTUNITY

SPONSORSHIP TIERS

★ HOME RUN LEVEL
\$75,000

- Prominent Logo Placement on Facilities
- Exclusive Advertising Opportunities
- Social Media Features and Mentions

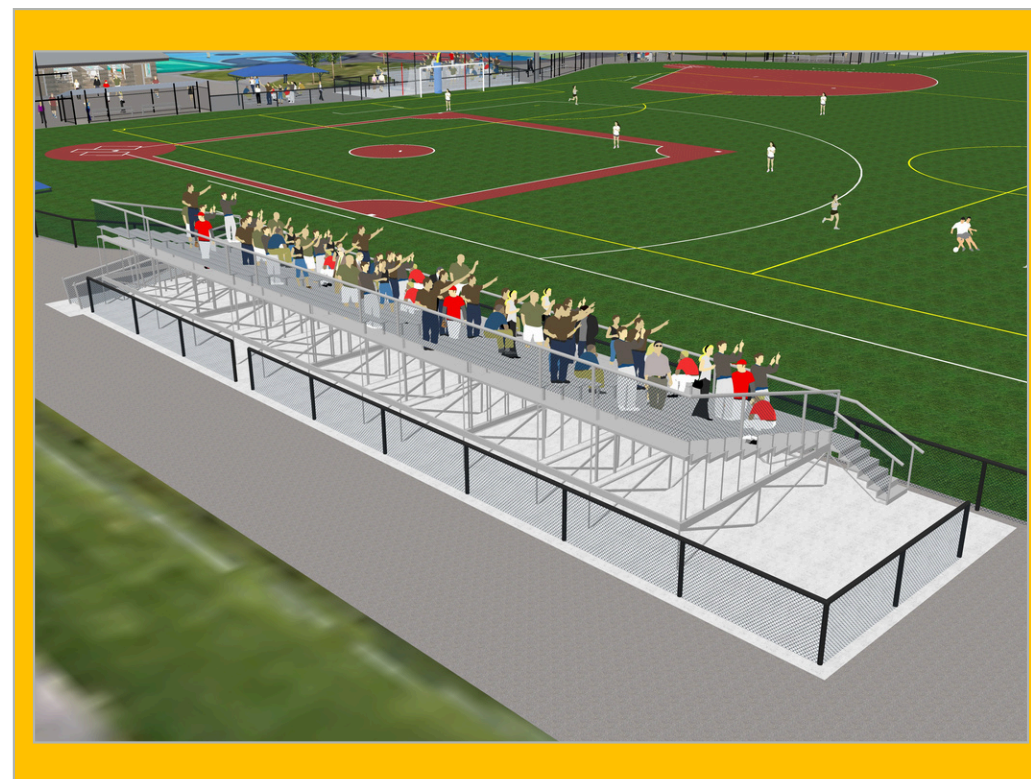

Friends of DeWitt Parks & Recreation Board

President – Dennis Cleary

Vice President – Jennifer Savastino

Treasurer – Mark Hall

Secretary – Patricia Sawmiller

Dom Cambareri

Jack Dooling

Rebecca Shiroff

Ed Michalenko

Kerry Mannion

Ryan Goff

Garrett Campbell

Christopher Hoch

Sean O'Brien

The Friends of Board is the managing entity over Carrier Park.



Sponsorship Contacts

Dom Cambareri

dom.thecambarerifamily@gmail.com

315-440-5468

*To Note Naming Rights will extend for a period of 5 calendar years